

Featured Project

"K" Street Streetscape Project

Sacramento, California

ArcSine Engineering provided electrical engineering services for the "K" Street Streetscape Project (between 7th and 8th Streets), located in the historic downtown district of Sacramento, California.

The estimated project construction cost is \$4 million, which includes redesign of the St. Rose of Lima Park, relocation of rapid Transit's (RT) St. Rose of Lima Park light rail station (7th & "K" Streets).

Key design objectives were to aesthetically improve the corridor, increase safety for pedestrians, enhance transit stops and connections for RT stations, improve pedestrian lighting and mobility, and to create a safe and inviting public space.

ArcSine Engineering performed the following:

- Extensive field investigation.
- Extensive coordination with the following agencies:
 - AT&T
 - Rapid Transit Light Rail System
 - SMUD
 - City of Sacramento
 - City Police Department
 - Other design consultants
- Preparation of demolition drawings.
- Selection of decorative pedestrian and street lighting poles for committee review.
- Power/lighting design for all pedestrian areas and "K" Street between 7th and 8th Streets.
- Power/site lighting design for St. Rose of Lima Park.
- Power distribution for well receptacles (vendors).
- Reallocation of existing underground raceways in improvement design.
- Power/lighting/communications design for the relocation of RT station, RT's communications cabinet, and fare vending machines.
- Prepared design for the relocation of traffic signal conductors.
- Power and cabling design for new CCTV security cameras on 7th and "K" Streets.
- Complete services during construction and on-going support.

Electrical
Lighting Design
Power Distribution
Construction Services



St. Rose Lima Park "before"

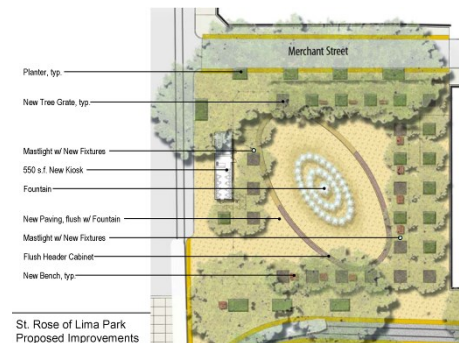

St. Rose Lima Park "after"

